

# Obi S

OBI 010 013 009S 9040 10 40 SD 40 00



Surface Mounted Surface Mounted Luminary



|                                      |  |
|--------------------------------------|--|
| <b>Luminaire Group</b>               | Surface Mounted                              |
| <b>Mounting Type</b>                 | Surface Mounted                              |
| <b>Luminaire Color</b>               | RAL 9005 - RAL 9016                          |
| <b>Housing</b>                       | Aluminum Injection                           |
| <b>Optics</b>                        | 15° 30° 40° Reflector & Transparent Diffuser |
| <b>Light Source</b>                  | LED  |
| <b>Electrical Protection Class</b>   | CLASS II                                     |
| <b>IP</b>                            | 40   |
| <b>IK</b>                            | 02   |
| <b>Operating Temperature</b>         | -20°C / +40°C                                |
| <b>Luminous Flux</b>                 | 630  |
| <b>Consumption Power</b>             | 9  |
| <b>Luminaire Efficiency</b>          | 70 lm/W                                      |
| <b>Color Rendering (CRI)</b>         | >80  |
| <b>Light Color Temperature (CCT)</b> | 2700K/3000K/4000K/6500K                      |
| <b>Color Tolerance</b>               | < 3 SDCM                                     |
| <b>Driver Type</b>                   | On/Off                                       |
| <b>Driver Brand</b>                  | Tridonic                                     |
| <b>LED Brand</b>                     | Samsung                                      |
| <b>Input Voltage / Frequency</b>     | 220-240 V AC 50/60 Hz                        |
| <b>Power Factor</b>                  | >0.9   |
| <b>Surge</b>                         | 1kV  |
| <b>THD (AKIM)</b>                    | >%20   |
| <b>LED life</b>                      | 70.000 hours                                 |
| <b>Option</b>                        | On-Off / Dali / 1-10V / With Emergency Kit   |

Technical Drawing

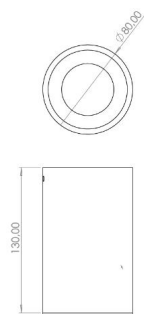

Photometric Curve

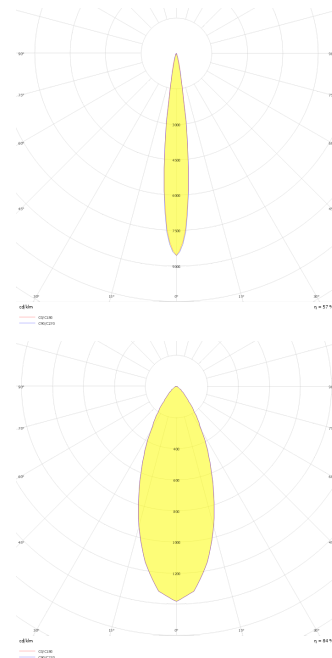

# Obi S

OBI 010 013 009S 9040 10 40 SD 40 00



Surface Mounted Surface Mounted Luminary

---

| SKU      | Product Code                         | Power (W) | Luminous Flux (LM) | CRI | CCT (K) | Optics                         | Dimensions (mm) |
|----------|--------------------------------------|-----------|--------------------|-----|---------|--------------------------------|-----------------|
| 15003028 | OBI 010 013 009S 9040 10 40 SD 40 00 | 9         | 630                | >80 | 4000    | 40°<br>Transparent<br>Diffuser | Ø102x130        |