

Obi S

OBI 010 013 013S 9040 10 15 SD 40 00



Surface Mounted Surface Mounted Luminary



| | |
|--------------------------------------|--|
| Luminaire Group | Surface Mounted |
| Mounting Type | Surface Mounted |
| Luminaire Color | RAL 9005 - RAL 9016 |
| Housing | Aluminum Injection |
| Optics | 15° 30° 40° Reflector & Transparent Diffuser |
| Light Source | LED |
| Electrical Protection Class | CLASS II |
| IP | 40 |
| IK | 02 |
| Operating Temperature | -20°C / +40°C |
| Luminous Flux | 910 |
| Consumption Power | 13 |
| Luminaire Efficiency | 70 lm/W |
| Color Rendering (CRI) | >80 |
| Light Color Temperature (CCT) | 2700K/3000K/4000K/6500K |
| Color Tolerance | < 3 SDCM |
| Driver Type | On/Off |
| Driver Brand | Tridonic |
| LED Brand | Samsung |
| Input Voltage / Frequency | 220-240 V AC 50/60 Hz |
| Power Factor | >0.9 |
| Surge | 1kV |
| THD (AKIM) | >%20 |
| LED life | 70.000 hours |
| Option | On-Off / Dali / 1-10V / With Emergency Kit |

Technical Drawing

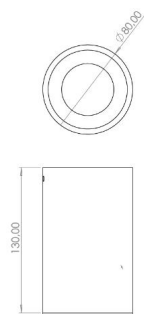

Photometric Curve

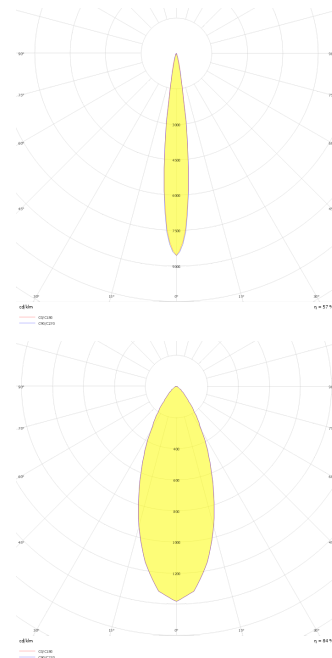

Obi S

OBI 010 013 013S 9040 10 15 SD 40 00



Surface Mounted Surface Mounted Luminary

| SKU | Product Code | Power (W) | Luminous Flux (LM) | CRI | CCT (K) | Optics | Dimensions (mm) |
|----------|--------------------------------------|-----------|--------------------|-----|---------|--------------------------------|-----------------|
| 15003044 | OBI 010 013 013S 9040 10 15 SD 40 00 | 13 | 910 | >80 | 4000 | 15° Transparent Diffuser | Ø102x130 |